

5822 HydroCap Foamer

Package Should Contain:

1. HydroCap Foamer unit.
2. Spray nozzle.
3. Quick coupler.
4. Chemical inlet tube, weight, and footvalve.
5. Metering tip kit.
6. Instruction sheet.

THANK YOU FOR YOUR INTEREST IN OUR PRODUCTS

. Please use this equipment carefully and observe all warnings and cautions.

*****NOTE *****

WEAR	protective clothing and eyewear when dispensing chemicals or other materials.
ALWAYS	observe safety and handling instructions of the chemical manufacturers.
ALWAYS	direct discharge away from you or other persons or into approved containers.
ALWAYS	dispense cleaners and chemicals in accordance with manufacturer's instructions. Exercise CAUTION when maintaining your equipment.
KEEP	equipment clean to maintain proper operation.
WEAR	protective clothing and eyewear when working in the vicinity of all chemicals, filling or emptying equipment or changing metering tips.
ALWAYS	re-assemble equipment according to instruction procedures. Be sure all components are firmly screwed or latched into position.
ATTACH	only to tap water outlets (85 PSI maximum).
NOTE	If the unit is used to fill a sink or the discharge hose can be placed into a sink, the unit must be mounted so that the bottom of the cabinet is above the overflow rim of the sink.

Installation and Operation:

1. Remove HydroCap Foaming unit from box.
2. Select metering tip (see next section) and insert into the chemical inlet stem.
3. Install chemical inlet tube over metering tip and onto inlet stem.
4. Place HydroCap Foaming unit onto chemical container and seal by turning cap until tight. NOTE: Cap will independently turn.
5. Connect female quick connect on spray gun to male quick-connect of HydroCap foamer
6. Connect a garden hose with 3/4" male garden hose thread to the base of the spray nozzle handle. Turn on the water supply to the hose. (Minimum 25 PSI water pressure is required to operate the foamer.)
7. To disconnect, turn off water source. Release the quick-connect to separate nozzle from HydroCap foamer.



Metering Tip Selection:

The final concentration of the dispensed solution is related to both the size of the metering tip opening and the viscosity of the liquid being siphoned. For water-thin products, the chart at right can be used as a guideline. If product is noticeably thicker than water, consult the Measurement of Concentration Procedure below to achieve your desired water-to-product ratio. Because dilution can vary with water temperature and pressure, actual dilution achieved can only be ascertained by using the Measurement of Concentration Procedure. The clear, undrilled tip is provided to permit drilling to size not listed should you need a dilution ratio that falls between standard tip sizes.

NOTE: Refer to parts diagram if unfamiliar with names of system components.

Measurement of Concentration:

You can determine the dispensed water-to-product ratio for any metering tip size and product viscosity. All that is required is to operate the primed dispenser for a minute or so and note two things: the amount of dispensed solution, and the amount of concentrate used in preparation of the solution dispensed. The water-to-product ratio is then calculated as follows:

Dilution Ratio (X:1) where $X = \frac{\text{Amount of Mixed Solution}}{\text{Amount of Concentrate Drawn}}$

APPROXIMATE DILUTIONS AT 40 PSI FOR WATER-THIN PRODUCTS			
Tip Color	Orifice Drill	Std. Size	Ratio
			2.5 GPM
No Tip	.187	(3/16)	6:1
Grey	.128	(30)	6.5:1
Black	.098	(40)	7:1
Beige	.070	(50)	8:1
Red	.052	(55)	12:1
White	.043	(57)	18:1
Blue	.040	(60)	20:1
Tan	.035	(65)	24:1
Green	.028	(70)	32:1
Orange	.025	(72)	44:1
Brown	.023	(74)	64:1
Yellow	.020	(76)	72:1
Aqua	.018	(77)	96:1
Purple	.014	(78)	128:1
Pink	.010	(87)	170:1

Parts Diagram List:

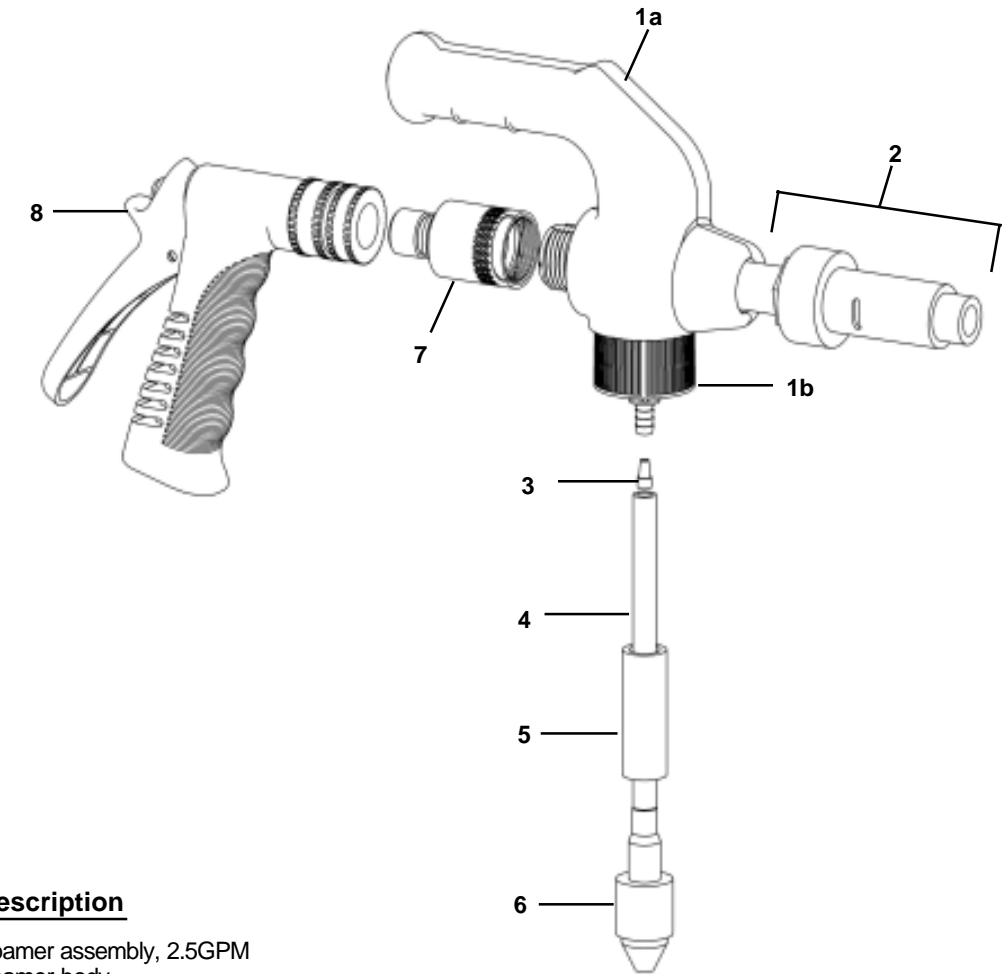

Key	Part No.	Description
1	10089269	Foamer assembly, 2.5GPM
a		Foamer body
b		Cap
2	10089275	Foamer nozzle assembly
3	690014	Metering tip kit
4	10062550	Tubing, 1/4" x 2'
5	509900	Weight
6	10076301	Footvalve, viton
7	10089280	Quick connect, male
8	10083711	Spray nozzle

TROUBLESHOOTING CHART:

Problem	Cause	Solution
1. No discharge	a. No water b. Eductor clogged	a. Open water supply b. Clean or replace
2. No concentrate draw	a. Metering tip or eductor has scale build-up b. Low water pressure	a. Clean (descale)* or replace b. Minimum 25 PSI (with water running) required to operate unit properly
3. Excess concentrate draw	a. Metering tip not in place	a. Press correct tip firmly into barb on pick-up stem
4. Failure of unit to turn off	a. Excessive water pressure	a. Install regulator if pressure (with water flowing) exceeds 60 PSI

Amount of Concentrate Drawn Dilution Ratio, then, equals X parts water to one part concentrate (X:1). If the test does not yield the desired ratio, choose a different tip and repeat the test. Alternative methods to this test are 1) pH (using litmus paper), and 2) titration. Contact your concentrate supplier for further information on these alternative methods and the materials required to perform them.