

**Troubleshooting Guide:**

Problem	Cause	Solution
1. Rinse aid not dispensing	a. Rinse diaphragm defective b. Clogged discharge line	a. Replace diaphragm. b. Clean or replace discharge line
2. Rinse aid not drawing from container	a. Rinse diaphragm defective	a. Replace diaphragm
3. Leaking pump	a. Pressure diaphragm defective	a. Replace diaphragm



# DishPro

## Hydraulic Warewash Pump

### Model 6530

**Package Should Contain:**

1. DishPro unit
2. Water inlet fitting
3. 1/4" x 7' (2.1m) chemical inlet tube with foot strainer and weight
4. Metering tip kit
5. Rinse tubing, 1/4" x 6' (1.8m)
6. Rinse check valve
7. (3) screws and (3) wall anchors for wall mounting use 9/32" (7mm) drill
8. Instruction sheet

**THANK YOU FOR YOUR INTEREST IN OUR PRODUCTS**

Please use this equipment carefully and observe all warnings and cautions.

\*\*\*\*\*NOTE \*\*\*\*\*

- WEAR** protective clothing and eyewear when dispensing chemicals or other materials or when working in the vicinity of all chemicals, filling or emptying equipment or changing metering tips.
- ALWAYS** observe safety and handling instructions of the chemical manufacturer.  
direct discharge away from you or other persons or into approved containers.  
dispense cleaners and chemicals in accordance with manufacturer's instructions. Exercise **CAUTION** when maintaining your equipment.  
reassemble equipment according to instruction procedures. Be sure all components are firmly screwed or latched into position.
- KEEP** equipment clean to maintain proper operation.

**Installation Requirements:**

- Minimum rinse line pressure 15 psi (1.0 bar)
- Maximum water temperature 180 degrees F (82 degrees C)
- To ensure proper operation of DishPro Unit, product containers should be placed within 6' (1.8m) of DishPro Unit. Do not place product containers above pump.

**Installation of DishPro Unit:**

1. Turn off water supply to dish machine before DishPro unit installation.
2. Remove cover from DishPro unit.
3. Determine placement of DishPro on the dish machine or a nearby wall.
4. Mark mounting holes (right) using unit back as template. Drill 9/32" (7mm) holes and insert wall anchors. Install left mounting screw halfway into wall anchor allowing space for cover to be secured. Tighten right mounting screw.
5. Remove both 1/8" NPT plugs in dish machine (Install 1/8" street tee - not supplied - if only one 1/8" NPT port is available.)
6. Install water inlet fitting (right) to dish machine or street tee.



8. Install rinse check valve (right) in dish machine or street tee. **NOTE: RINSE CHECKVALVE SHOULD BE INSTALLED DOWNSTREAM OF WATER INLET FITTING.**



9. Connect one end of 1/4" rinse tubing to rinse check valve.
10. If parts are not available, contact local installer for available options.

11. Select metering tip using dosage chart (p. 2). Install metering tip into open end of 1/4" rinse tubing with metering tip into the outlet checkvalve compression fitting (a) on DishPro unit. Tighten outlet checkvalve compression fitting (c) (do not over-tighten). Set adjustment cap to the proper dosage (1, 2, 3, or 4cc). Adjustment is made by turning the cap counterclockwise and moving up or down to the desired dose (d). The cap is locked in place by turning the cap clockwise.

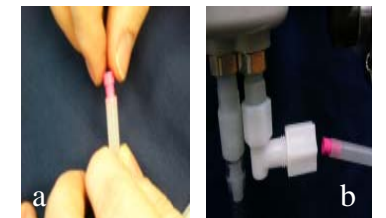

**DishPro Parts Diagram:**

12. Cut supply tubing provided to reach from inlet check valve to bottom of the concentrate container (a). Slide a ceramic weight over one end of tube and slide a foot valve into the same end of the tube.

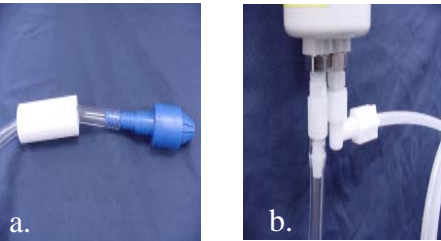

13. Place pickup tubing with foot valve into rinse aid container and connect tubing end to the inlet check valve on the DishPro Unit (b).

14. Prime rinse aid tubing by pumping the bottom of the DishPro unit until rinse aid can be seen in the rinse line (at the dish machine check valve) or by cycling the rinse valve on and off.



15. Place cover on DishPro unit. Mark far right mounting hole using cover as template. Drill 9/32" (7mm) hole and insert wall anchor. Tighten mounting screw to secure cover.

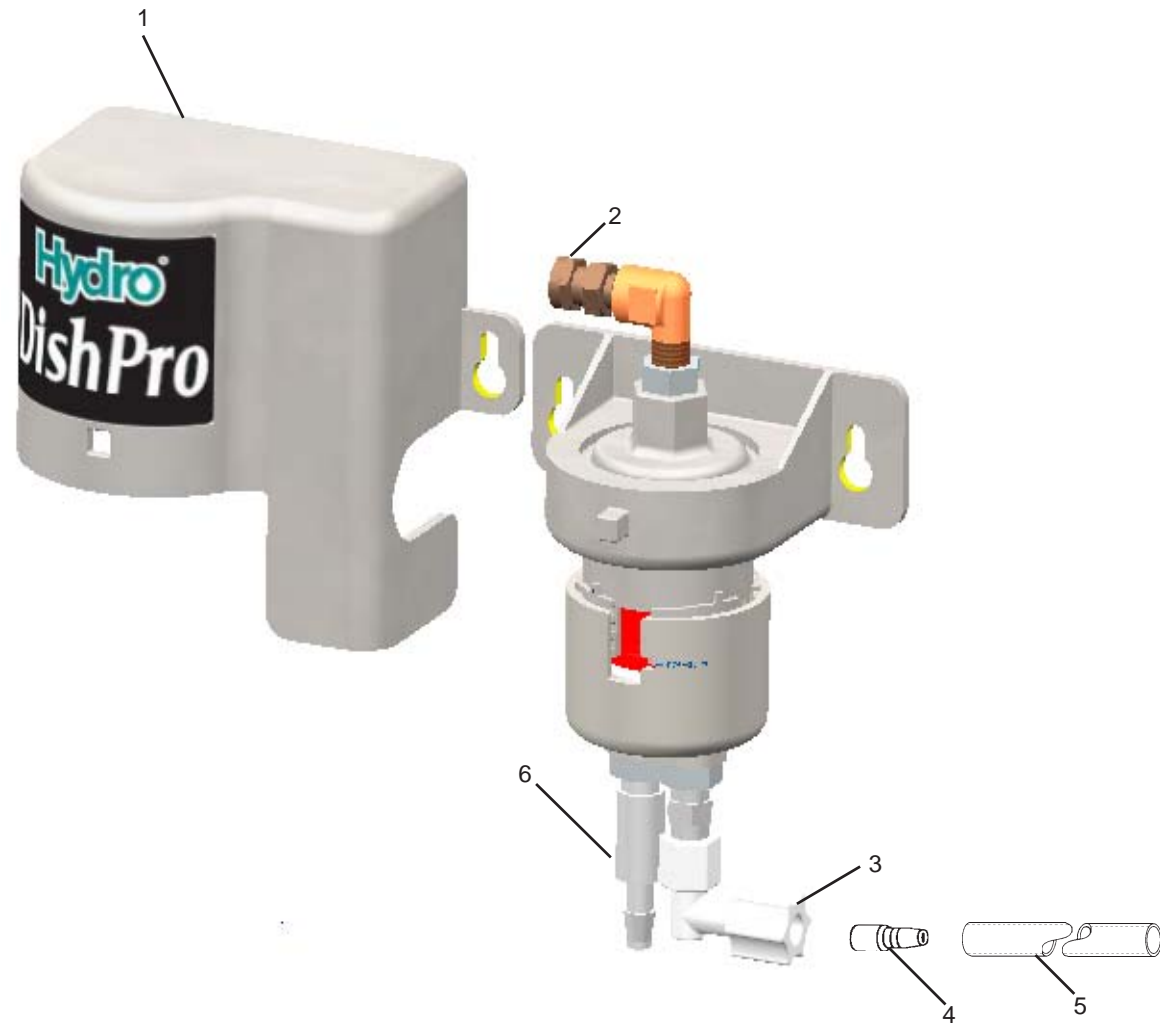

**Dosage Chart:**

The rinse dosage time (the amount of time in the rinse cycle over which the rinse aid can be injected) can be adjusted by installing a metering tip into the end of the 1/4" rinse tubing that installs in the rinse check valve on the DishPro unit. Use the dosage chart below as a guideline for determining the tip that achieves the desired rinse dosage time (in seconds).

COLOR	SIZE	1cc Dosage			2cc Dosage			3cc Dosage			4cc Dosage		
		15psi	20psi	25psi	15psi	20psi	25psi	15psi	20psi	25psi	15psi	20psi	25psi
BLACK	0.098										6.0		
RED	0.052							6.0			7.0		
BLUE	0.040							7.0			8.0		
TAN (MED)	0.035	6.0			6.0			8.0			10.0	6.0	
GREEN	0.028	7.0			7.0	6.0		9.0	6.0		11.0	7.0	
BROWN (DK)	0.023	8.0			8.0	7.0		10.0	7.0		12.0	8.0	
YELLOW	0.020	9.0			9.0	8.0		11.0	8.0		13.0	9.0	6.0
PURPLE	0.014	10.0	6.0		10.0	9.0		12.0	9.0	6.0	14.0	10.0	7.0
LT. GREY	0.012	11.0	7.0		11.0	10.0	6.0	13.0	10.0	7.0		11.0	8.0
PINK	0.010	12.0	8.0	6.0	12.0	11.0	7.0	14.0	11.0	8.0		12.0	9.0
OLIVE-GREEN	0.008		12.0	9.0		12.0			14.0				

**PARTS LIST (Refer to diagram)**

Key #	Part Number	Description
1	10090677	Cabinet cover
2	10090619	Water inlet
3	10090630	Outlet check valve assy.
4	10090654	Metering tip kit
5	10090699	Tubing, 1/4" x 6'
6	10090623	Inlet check valve
not shown:		
	10090631	Kit, diaphragm DishPro