

user manual

Depletion Wand

contents

	introduction	2
1.	safety	3
2.	contents & description	4
	2.1 contents	4
	2.2 key features	5
	2.3 model list	5
	2.4 spare parts list	5
3.	dimensions and specifications	5
4.	site survey and installation requirements	6
5.	troubleshooting	6
6.	fitting mesh filter	6
7.	chemical drum assembly	7
8.	connecting to the low level alarm	7
9.	connecting to the Evoclean	8
10.	warranty	9
11.	decommissioning and disposal	10
12.	WEEE - waste electrical and electronic equipment	10
13.	electrical approvals	10

Introduction

Overview

Depletion wands simplify laundry installations by allowing quick connections between a single chemical drum and up to three laundry dispensers. In addition to limiting chemical spills and increasing the efficiency of replenishing product drums, the depletion wands come equipped with a float switch that can detect and alert users to costly out-of-product conditions. This reduces the risks of poor results and rewash.

Please look at and read these instructions carefully before starting installation and operation. Keep the Installation and User Manual for future reference.

Remove all packaging and check the Depletion Wand for missing parts against the Contents of Packaging or damage before starting installation.

Any alterations made to the Depletion Wand and fittings will invalidate the Warranty.

1. Safety



THANK YOU FOR YOUR INTEREST IN OUR PRODUCTS

Please use this equipment carefully and observe all warnings and cautions.



WARNING

Please read precautions thoroughly before operation. Meet all applicable local codes and regulations.

WEAR

Protective clothing and eye wear when dispensing chemicals or other materials or when working in the vicinity of all chemicals, filling or emptying equipment, or changing metering tips.

ALWAYS

Observe safety and handling instructions of the chemical manufacturer.
Direct discharge away from you or other persons or into approved containers.
Dispense cleaners and chemicals in accordance with manufacturer's instructions.
Exercise CAUTION when maintaining your equipment.
Reassemble equipment according to instruction procedures.
Be sure all components are firmly screwed or latched into position.

KEEP

Equipment clean to maintain proper operation.

- This unit is not to be used with ATEX chemicals
- This unit is not to be used with chemicals outside the temperature of 0-60°C

Do not mix cleaning chemical products.



Electrical

- All mains electrical work must be carried out in accordance with local and national regulations, and by a qualified electrician.
- The unit **MUST** be disconnected from its power source during cleaning, servicing or when replacing parts.
- The Alarm should only be operated at or within the voltage specified in this Installation and Manual.
- The installer and user are responsible for ensuring the installation and operation of this Alarm are in accordance with this Installation and User Manual and local and national regulations.

2. contents & description

38mm design (available in 10L and 20L sizes)

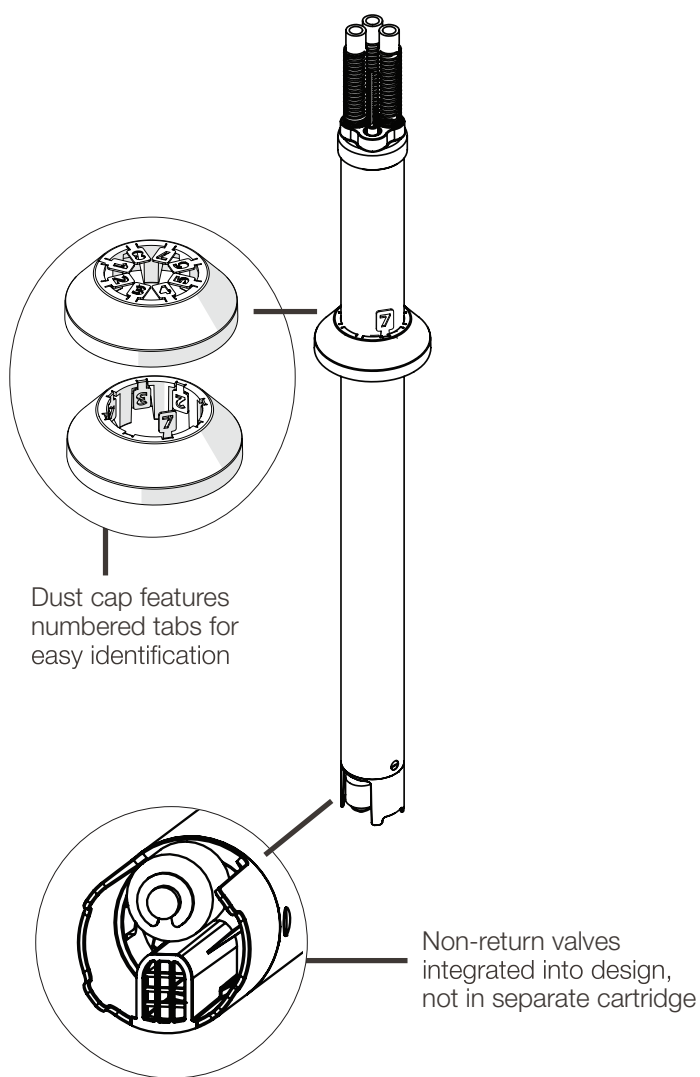

48mm design (available in 20L, 60L and 200L sizes)

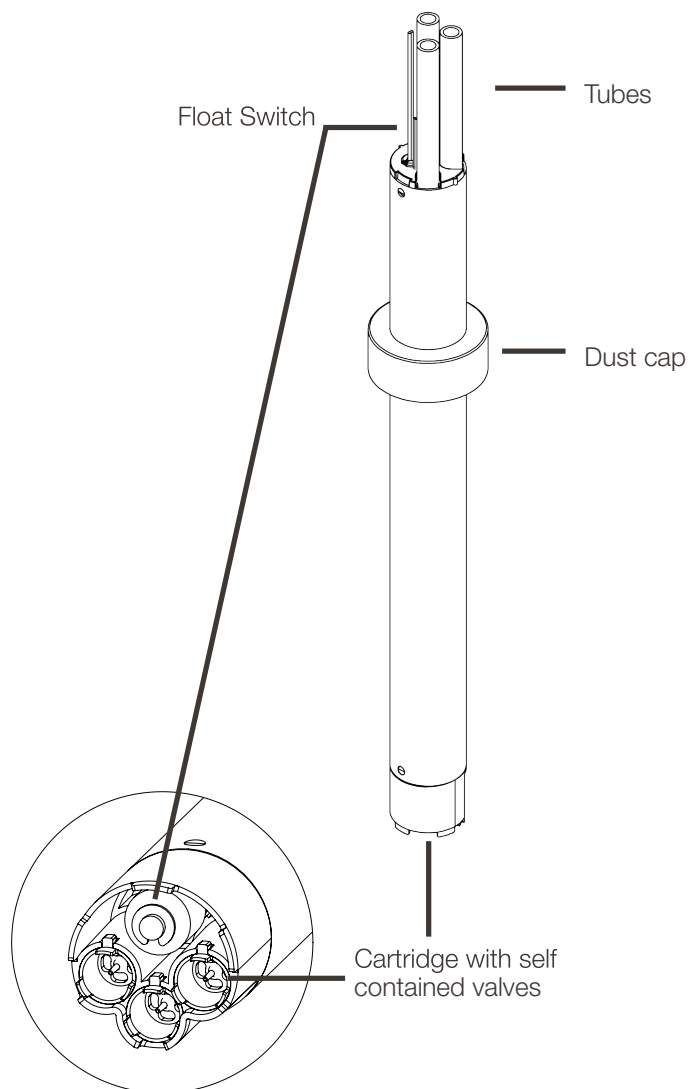

2.1 Package Contents

38mm models

- Depletion Wand
- Dust Cap
- Quick Start Guide
- 5/16 x 3/8 Hose Barb
- 5/16 x 1/2 Hose Barb
- 5/16 x 5/16 Hose Barb
- Tie Wraps
- Filter Mesh
- Plugs

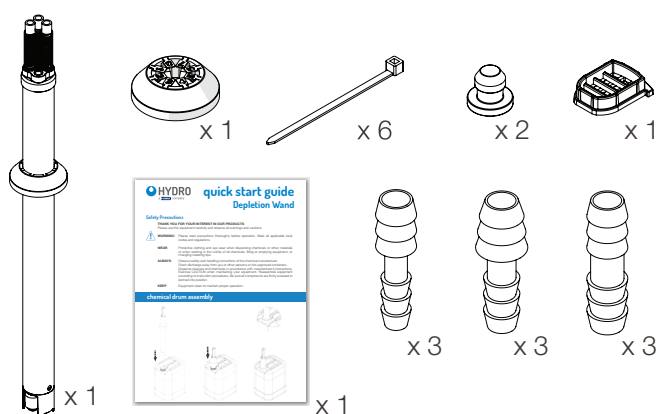

48mm models

- Depletion Wand
- Dust Cap
- Quick Start Guide
- 3/8 x 3/8 Hose Barb
- 3/8 x 1/2 Hose Barb
- 3/8 x 5/16 Hose Barb
- Tie Wraps

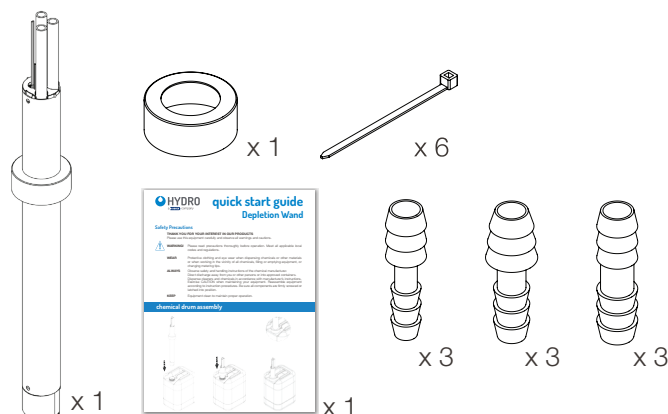

2.1 Key features:

The Depletion Wand is a robust drum interface for efficient chemical uptake.

The key features of the unit are as follows:

- Eliminate messy or unneeded pickup tubes with a 3-way system that allows one container to supply up to three separate laundry dispensers.
- Detect costly out of product conditions with a built-in low level float sensor
- Durable, reliable design using injection moulded plastic.
- System designed to maximize operator safety utilizing a spring on each tube and strain relief to prevent operator tube disconnection while in use.
- System is reliable and easy to maintain with umbrella-style non-return valves on all sizes. The umbrella valve prevents chemical or water from backing up into the drum and helps to maintain prime.
- Versatile design with multiple options to support global customer needs.
 - Two material grades for the non return valve including EPDM (EP) and Aflas (AF)
 - Multiple sizes to fit different chemical containers, including 10L, 20L, 60L and 200L.
 - Flexible to connect to an EvoClean dispenser or standalone alarm unit

2.2 Model numbers

Description	A (See section 3)	B (See section 3)	Drum Size (L) / (G)	Valve material
	Diameter (mm)	Length (mm)		
HYDDW10L380380D3AFF	38	380	10 / 2.5	Aflas
HYDDW20L380500D3AFF	38	500	20 / 5	Aflas
HYDDW20L0500D3EPF	48	500	20 / 5	EP
HYDDW60L0650D3EPF	48	650	60 / 16	EP
HYDDW200L1016D3EPF	48	1016	200 / 53	EP

2.3 Spare parts list: FOR 48MM MODELS ONLY

Part Number	Description	Pack size
HYD10099107	Umbrella valve cartridge kit (EPDM)	3
HYD10099108	Dust cap kit	5

3. dimensions and specifications

38mm design

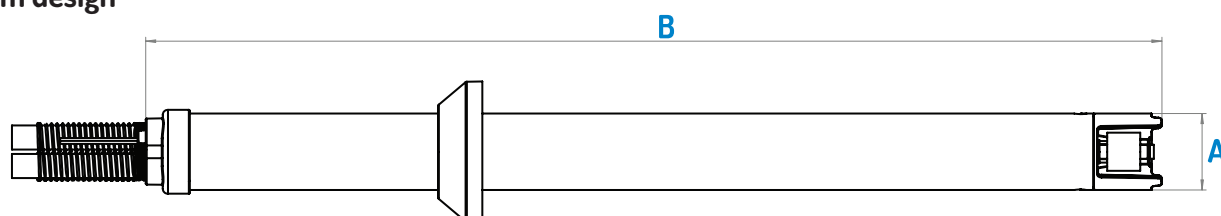

48mm design

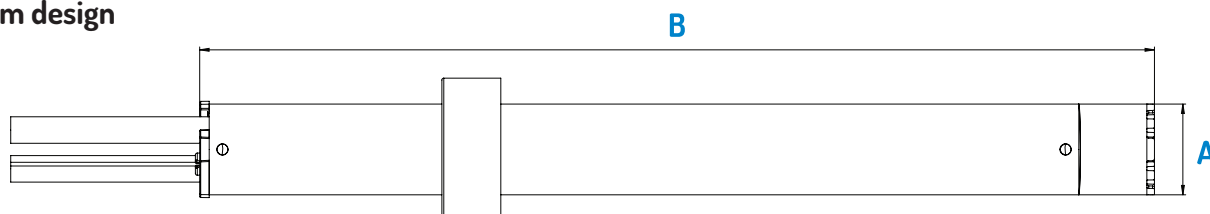

4. site survey and installation requirements

Before installation complete a site survey to ensure that the proposed site meets the requirements listed below:

- Ensure the floor around the unit is non-slip or suitable matting is provided to avoid slippages.
- A Risk Assessment for the area has been carried out
- There is sufficient room for operation and maintenance
- There is sufficient room on the floor for the chemical containers
- All mains electrical work must be carried out in accordance with local and national regulations, and by a qualified electrician.

5. trouble shooting

Fault	Root cause	Resolution
Alarm activates when chemical drum is full	Float Switch Orientation is incorrect (N/O / N/C)	Remove clip on end of the float switch and change float orientation
Alarm activates when chemical drum is full	Unit Continuity Configuration is Incorrect (NC / NO)	Change unit continuity configuration
Alarm does not activate when chemical drum is empty	Obstruction around float	Rinse float with water
Alarm does not activate when chemical drum is empty	Unit connected to depletion wand is not connected to mains power	Ensure unit connected to depletion wand is connected to a power source
Alarm does not activate when chemical drum is empty	Loose wiring	Ensure all wiring is connected to the unit fully
Chemical loses prime	Obstruction around umbrella valve	Rinse umbrella valve with warm water or replace as needed
Chemical compatibility	Chemical compatibility effects performance	Ensure chemical is compatible with material used on the depletion wand (see chemical datasheet)
Chemical is not priming	Air is entering the system	Ensure all hose barb connections are assembled fully and sealed

6. fitting mesh filter - 38mm design

On the 38mm design models, a mesh filter must be installed to the bottom of the wand. The mesh is simply pushed into place.

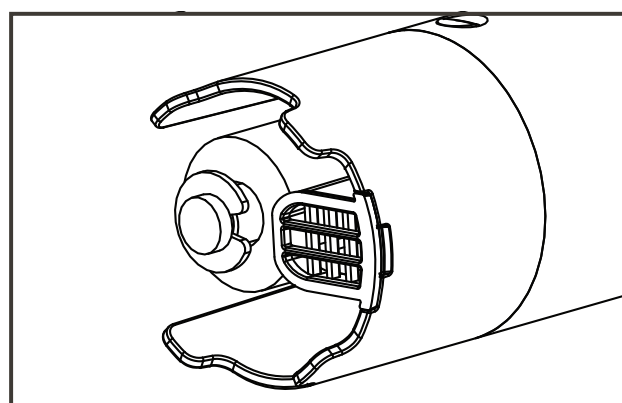
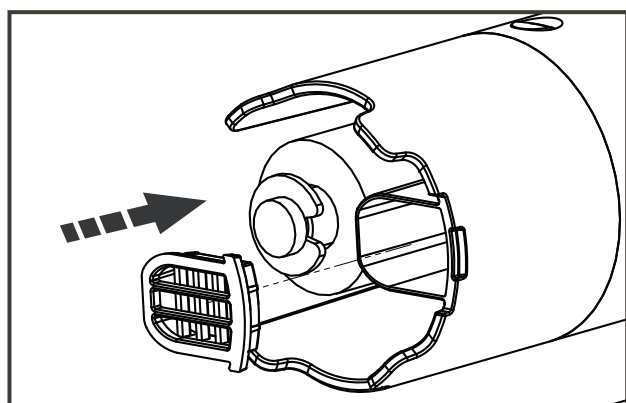

7. chemical drum assembly

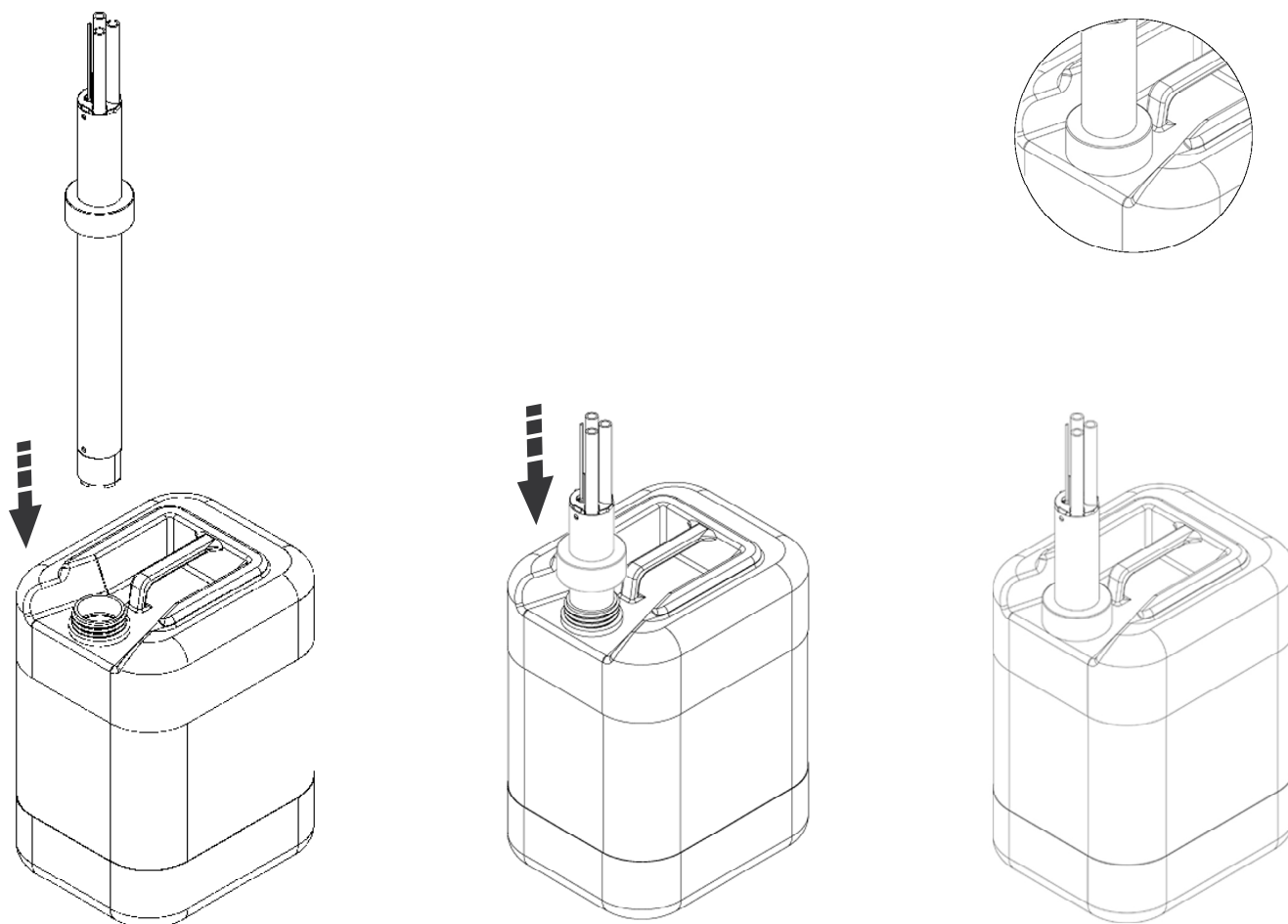

Note: 48mm design shown

8. connecting to the Low Level Alarm

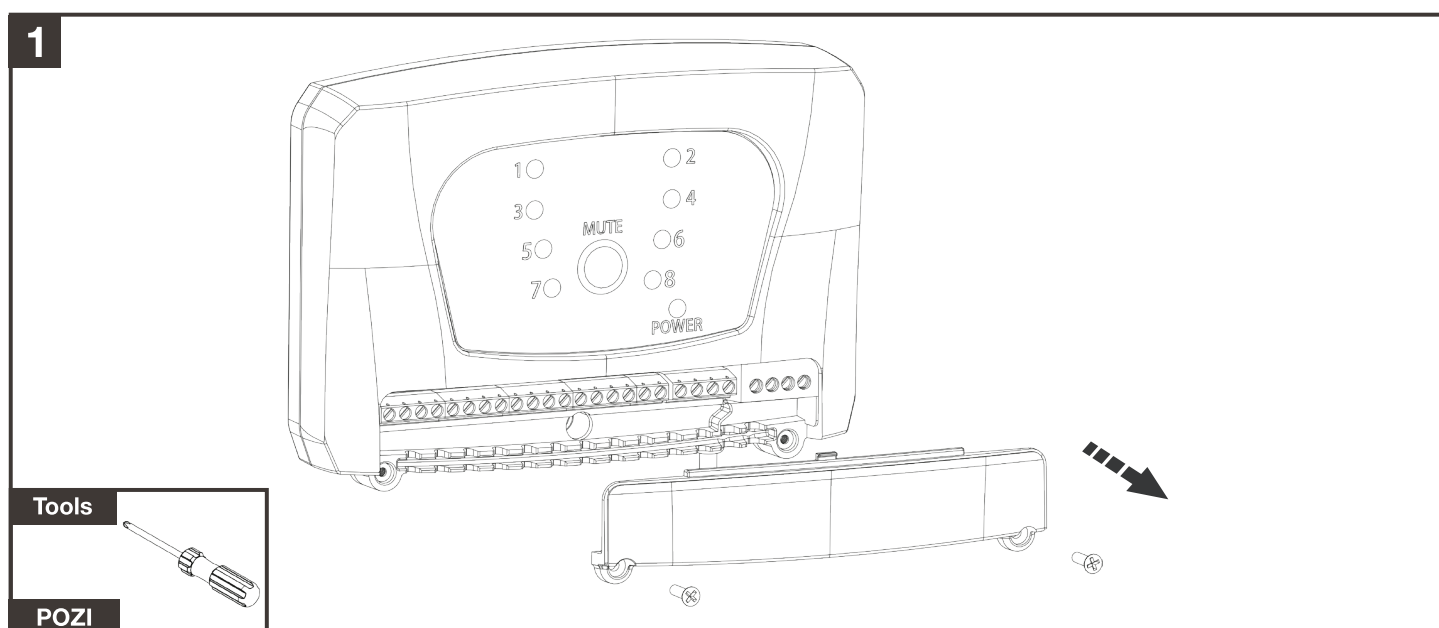

2

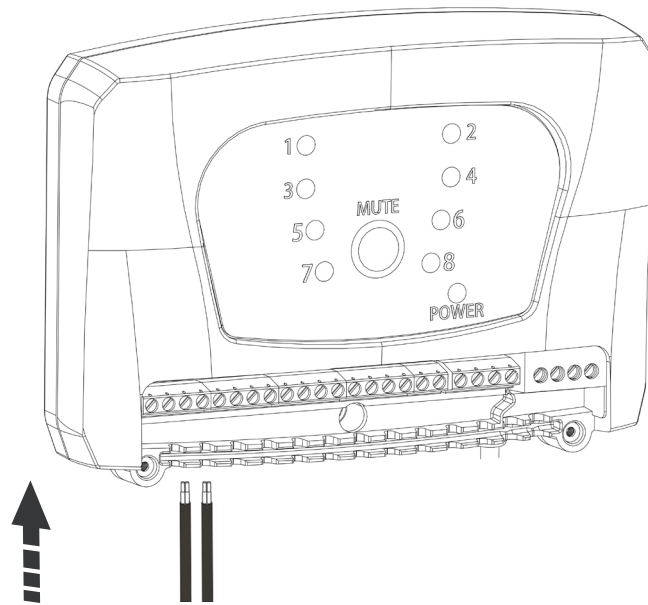

3

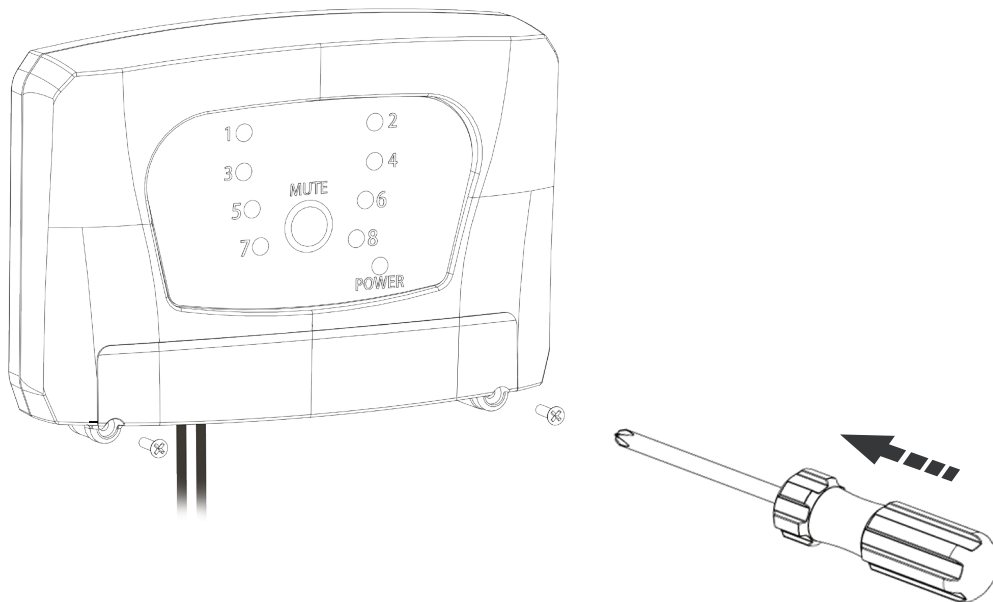

9. connecting to the EvoClean

1

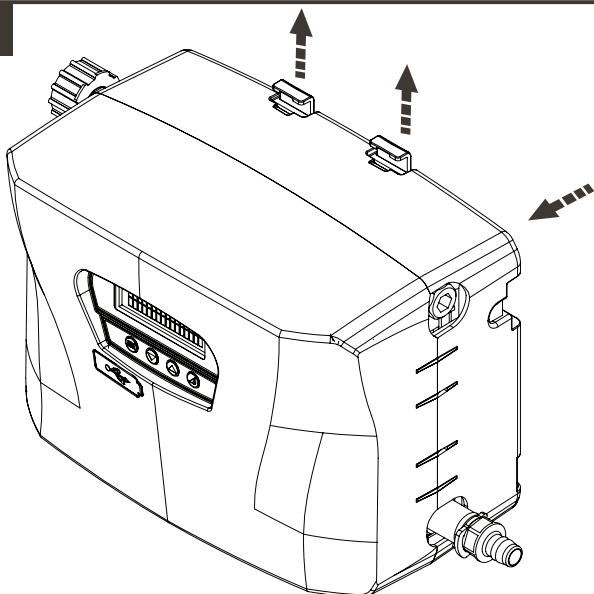

2

Drill hole in base of unit to allow for wiring

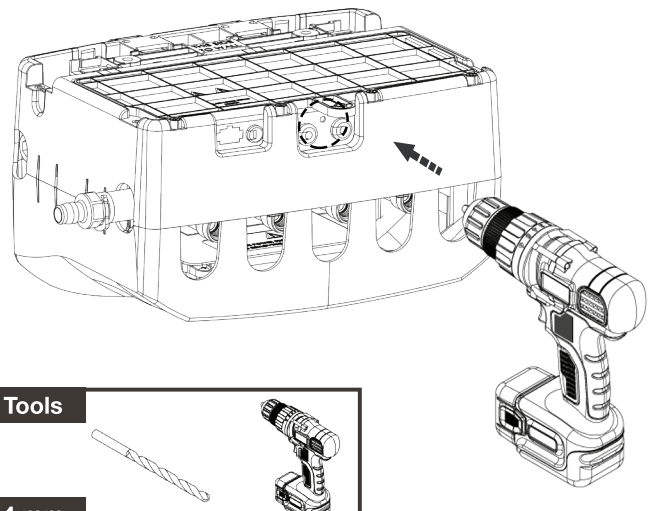

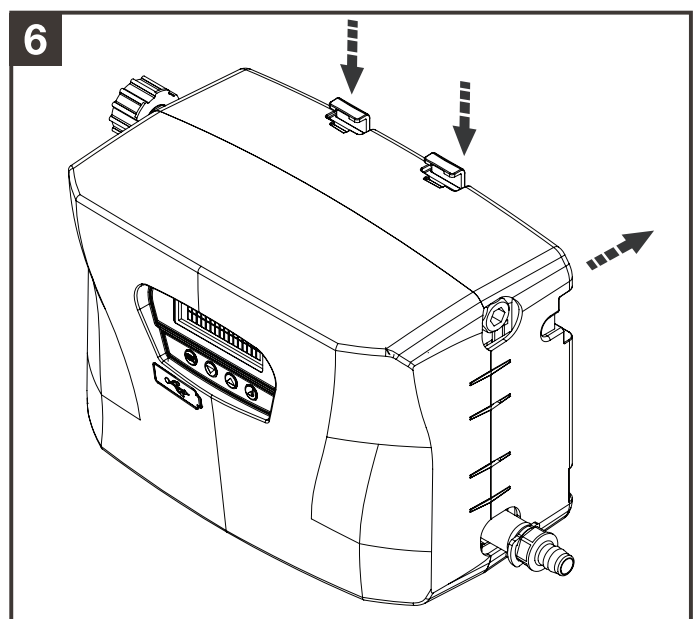
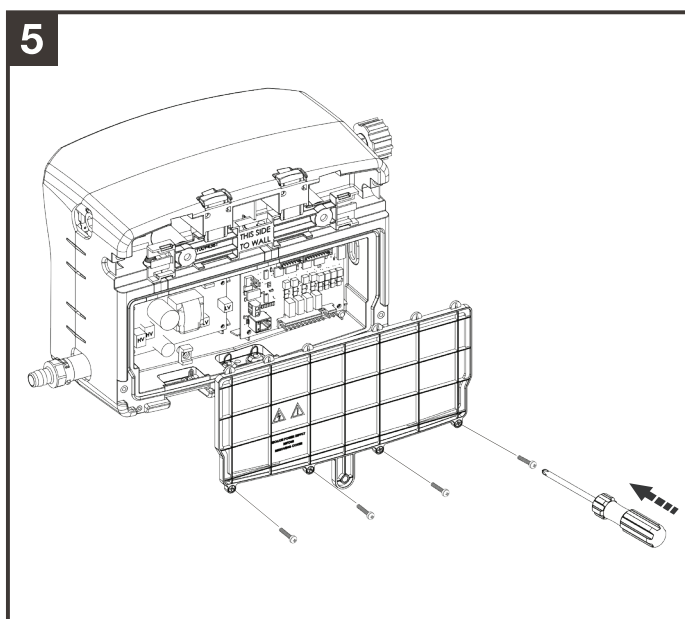
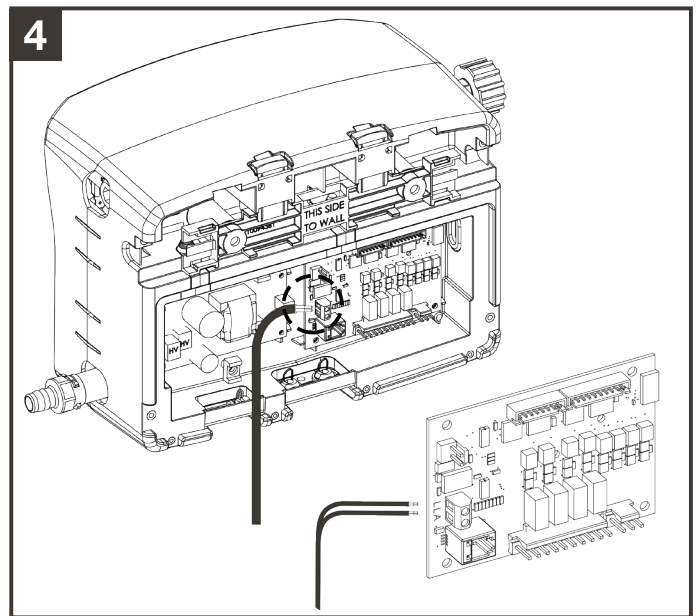
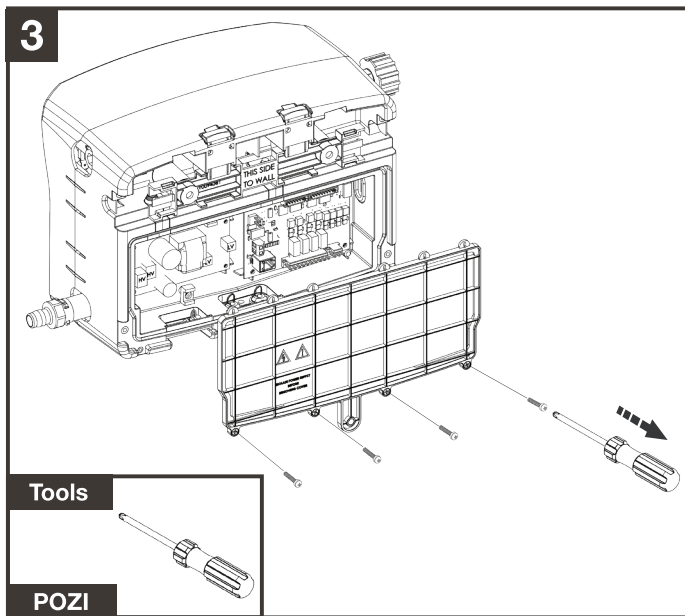

To connect multiple depletion wands, to the Evoclean unit, follow the same instructions, adding additional units in parallel.

10. warranty

Seller warrants solely to Buyer the Products will be free from defects in material and workmanship under normal use and service for a period of one year from the date of completion of manufacture. This limited warranty does not apply to (a) hoses; (b) and products that have a normal life shorter than one year; or (c) failure in performance or damage caused by chemicals, abrasive materials, corrosion, lightning, improper voltage supply, physical abuse, mishandling or misapplication. In the event the Products are altered or repaired by Buyer without Seller's prior written approval, all warranties will be void.

No other warranty, oral, express or implied, including any warranty of merchantability or fitness for any particular purpose, is made for these products, and all other warranties are hereby expressly excluded.

Seller's sole obligation under this warranty will be, at Seller's option, to repair or replace F.O.B. Seller's facility in Cincinnati, Ohio or Duisburg, Germany any Products found to be other than as warranted.

Limitation of Liability

Seller's warranty obligations and Buyer's remedies are solely and exclusively as stated herein. Seller shall have no other liability, direct or indirect, of any kind, including liability for special, incidental, or consequential damages or for any other claims for damage or loss resulting from any cause whatsoever, whether based on negligence, strict liability, breach of contract or breach of warranty.

11. decommissioning and disposal

Hydro products are manufactured from materials which can be recycled. Dispose of Hydro products in accordance with the current local regulations.

- All electrical connections have been removed and disposed of according to local regulations
- Any hazard Warning signs have been removed or totally defaced

- Safe for disposal sign/note appended to each piece of listed items
- The items have been left in a condition such that it is safe for lay personnel or contractor to remove it without need for precautions against exposure to any electrical supply or other agents.

12. WEEE – waste electrical and electronic equipment

WEEE Regulations apply to companies who Manufacture & Distribute electrical or electronic equipment. (EEE)

The WEEE Regulations apply to importers, producers, retailers and users of EEE, and to businesses that treat or recover WEEE. The Low Level Alarm unit is a product placed onto market POST 13.08.05 , therefore called 'future WEEE'. As a producer Hydro Systems have the option to take responsibility for the EEE placed on the market. If Hydro Systems chooses to receive WEEE they must make sure that it is disposed of in an environmentally sound way, including the treatment, reuse, recovery and recycling of the components where appropriate.

Responsibility as a producer of EEE

Hydro Systems, as a producer of EEE, are registered with a producer compliance scheme who register them with the relevant environmental regulator.

Through the regulator they become part of an approved producer compliance scheme (PCS).The PCS supply a unique and permanent producer registration number.

If disposal is outsourced it (the product) must be taken to an appropriately licensed site (approved authorised treatment facility - AATF) where it can be treated safely.

13. electrical approvals

Compliance to standard and test data / EC declaration of conformity.

This depletion wand complies with the following EU directives;

RoSH Complaint to Directive 2011/65/EU



Hydro Systems
3798 Round Bottom Road
Cincinnati, OH 45244

Phone 513.271.8800
Toll Free 800.543.7184
Fax 513.271.0160
Web hydrosystemsco.com

HYD10099798
REV 5

Depletion Wand
12/2022