

Safety Precautions



WARNING! Please read these warnings carefully and follow all applicable local codes and regulations.

THANK YOU FOR YOUR INTEREST IN OUR PRODUCTS!

TO AVOID SERIOUS PERSONAL INJURY AND PROPERTY DAMAGE:

- WEAR** protective clothing and eyewear when dispensing chemicals or other materials, when working in the vicinity of chemicals, and when filling or emptying equipment.
- ALWAYS** read and follow all safety instructions in safety data sheets (SDS) for all chemicals. observe all safety and handling instructions of chemical manufacturer. dilute and dispense chemicals in accordance with chemical manufacturer's instructions. regularly inspect equipment and keep equipment clean and properly maintained.
- NEVER** mix incompatible chemicals that pose hazards.
- ATTACH** only to warewash reservoirs. Do not exceed switch temperature rating of 230° F (110° C). Operating outside of these parameters will void manufacturer's warranty.

introduction

Package Contents

DM-6000 Float Switch Accessory Kit (P/N 1009884 - Float Switch Assembly and Mounting Hardware)

- a. Float switch assembly with flying leads
- b. 0.875" O.D. black neoprene gasket
- c. 1.5" O.D. white shoulder washer
- d. 1.5" O.D. black rubber washer
- e. 1.5" O.D. gray plastic washer
- f. Black retaining nut
- g. Qty. 2 - butt splice connectors (not shown, for connecting flying leads)

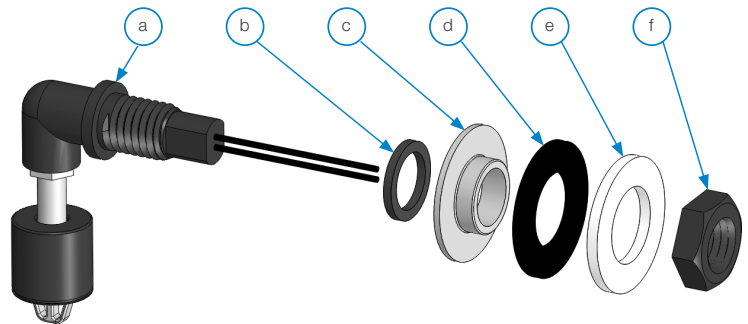

installation

1. Locate the 0.875" hole punch-out in the dishwasher tank and ensure that there is adequate room for the switch to operate below the punch-out (at least 2.5"). If there is not adequate space below the punch-out, the float must be reoriented to support being installed in an upward position. This is done by pressing the two tabs inward and sliding the float from the shaft of the switch, reorienting, and then sliding the float back over the shaft in the correct position. Please take note of the proper location of the seam of the float switch in the two orientations, as shown.

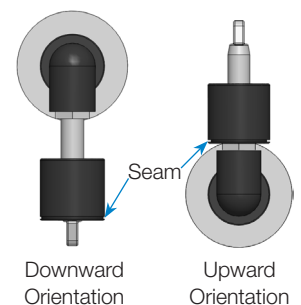

installation (continued)

2. Prepare the float switch for installation by removing the retaining nut and gray plastic washer from the assembly. The threaded section of the float switch should have the 0.875" O.D. black neoprene gasket, 1.5" O.D. white shoulder washer, and 1.5" O.D. black rubber washer installed in sequence.
3. Routing the float switch from the inside of the wash tank, push the flying leads and threaded section through the punch-out hole to the outside of the wash tank.
4. Place the gray, plastic washer onto the threaded shaft of the float switch on the outside of the tank and secure it in place with the lock nut.
5. With the lock nut loose, correctly orient the float switch, such that the float is facing downward inside the tank. (Or upward if you have reoriented the float.)
6. Tighten the retaining nut using an adjustable wrench to compress the washers and seal the unit to the tank.
7. Using the included butt splice connectors, connect one side of each connector to the float switch flying leads. Then strip the conductivity probe wires from the DM-6000 per the guideline shown and connect the corresponding wires to the other side of each connector.
8. The float switch must be enabled in the DM-6000 menus. Go to the INSTALLER MENU (and enter the installer password) \blacktriangleright INITIAL SYSTEM SETUP \blacktriangleright (scroll down to) FLOAT SWITCH FILL \blacktriangleright (highlight) ENABLE (and press \blacktriangleright). If your INITIAL SYSTEM SETUP menu does not have the FLOAT SWITCH FILL item at the bottom, talk to your Hydro Systems contact about getting a software update.

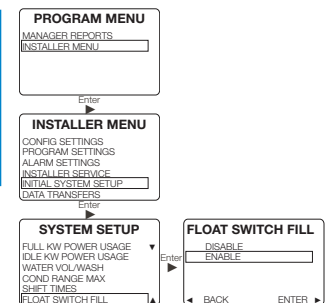
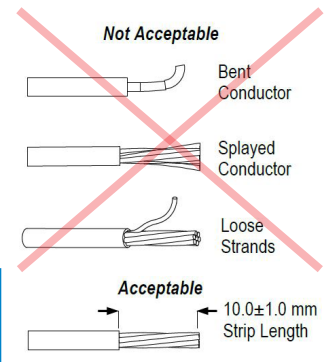

Limited Warranty

Seller warrants solely to **Buyer** the Products will be free from defects in material and workmanship under normal use and service for a period of one year from the date of completion of manufacture. This limited warranty does not apply to (a) hoses; (b) and products that have a normal life shorter than one year; or (c) failure in performance or damage caused by chemicals, abrasive materials, corrosion, lightning, improper voltage supply, physical abuse, mishandling or misapplication. In the event the Products are altered or repaired by **Buyer** without **Seller's** prior written approval, all warranties will be void. **No other warranty, oral, express or implied, including any warranty of merchantability or fitness for any particular purpose, is made for these products, and all other warranties are hereby expressly excluded.**

Seller's sole obligation under this warranty will be, at **Seller's** option, to repair or replace F.O.B. **Seller's** facility in Cincinnati, Ohio any Products found to be other than as warranted.

Limitation of Liability

Seller's warranty obligations and **Buyer's** remedies are solely and exclusively as stated herein. **Seller** shall have no other liability, direct or indirect, of any kind, including liability for special, incidental, or consequential damages or for any other claims for damage or loss resulting from any cause whatsoever, whether based on negligence, strict liability, breach of contract or breach of warranty.



Hydro Systems
3798 Round Bottom Road
Cincinnati, OH 45244

Phone 513.271.8800
Toll Free 800.543.7184
Fax 513.271.0160
Web hydrosystemsco.com

HYD10098878 Rev C 08/17